

PRESCRIPTION TREATMENT® brand 4 ALLURE®

STORED PRODUCT MOTH KIT

PT® 4 ALLURE® Trap Assembly Instructions:

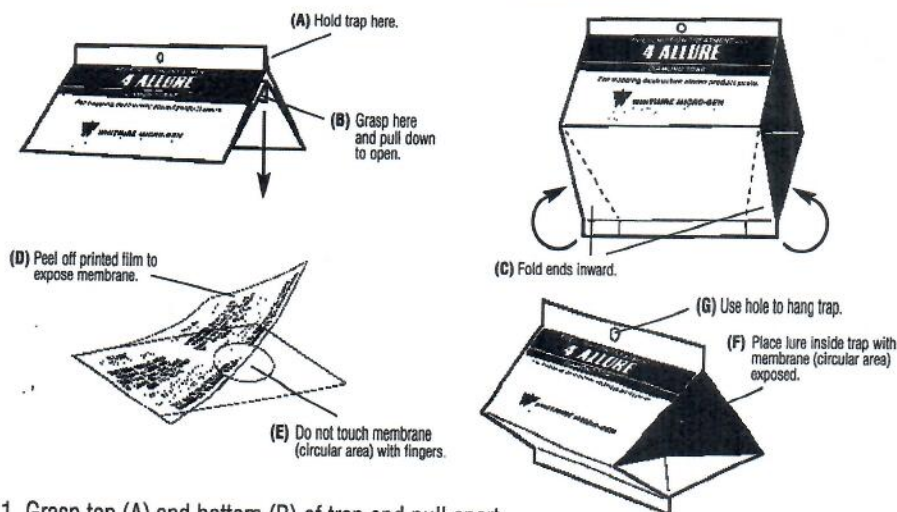

1. Grasp top (A) and bottom (B) of trap and pull apart.
2. Fold perforated ends (C) inward to hold the trap in three dimensional shape as shown.
3. Activate pheromone lure by peeling off printed film (D) to expose membrane (E). Do not touch exposed membrane with fingers.
4. Place the lure inside trap in the glue on underside of the top of trap (F). To function properly, lures must be placed inside trap with membrane (circular area) facing away from glue.
5. Use the hole on top of trap (G), to hang in appropriate locations with wire or string.

Trap Placement and Use:

For monitoring, evenly space traps in a grid system. Use one trap per 30,000 cubic feet. Hang in appropriate locations with wire or string. Record trap counts on the Whitmire Micro-Gen ALLURE® Monitoring Record form.

To find infestations within the facility, move traps from uninfested areas to the area where moths have been captured, increasing trap density to as much as one trap per 9,000 cubic feet. Close inspection in the area of maximum trap catch should reveal the infestation source.

Mass trapping can be accomplished with trap densities of one or more traps per 3,000 cubic feet, depending on the size of the moth population. Inspect traps weekly and remove insects and debris. Replace trap if insects, dust, or debris reduce stickiness. The pheromone lure lasts 16 weeks and can be removed and used on new traps.

Obtain further information and local recommendations from your state Agricultural Extension Service, local pest control company, or a consulting entomologist.

Note: To prolong storage life of the pheromone packet, refrigerate or freeze. Use tweezers or rubber gloves in handling to avoid contaminating packets when different ALLURE products are being used. Do not damage the lure membrane by stapling, pinning or nailing the packet to the trap.

Indian Meal Moth *Plodia interpunctella* (Hubner)



(Lure attracts several related species: Almond Moth, Mediterranean Flour Moth, Raisin Moth, Tobacco Moth.)

COMMODITIES ATTACKED:

Whole wheat or graham flour, cornmeal, shelled or ear corn, broken grain and grain products, dried fruits, seeds, crackers, biscuits, nuts, powdered milk, chocolate, candy, red peppers, dog food, tobacco and cocoa beans.

GEOGRAPHIC RANGE:

Worldwide

IDENTIFICATION:

Adult - All have narrow forewings and broad hind wings and labial palps which project forward forming a snout. Indian Meal Moths are $\frac{3}{8}$ " to $\frac{1}{2}$ " (10-13 mm) long with a wingspan of $\frac{3}{8}$ " to $\frac{3}{4}$ " (16-20 mm). Forewings are silver-grey, with outer two-thirds coppery brown; hind wings are dirty white. Other species are similar in appearance with grey mottled wings.

Larvae - Larvae of the different species are hard to distinguish, appearing dirty white; but may be yellow, pink, brown or greenish depending on the food source.

LURE DURATION:

16 weeks



WHITMIRE MICRO-GEN
Prescription Treatment

Making pest management more profitable.



We create chemistry

Safety Data Sheet

PT 4 ALLURE

Revision date : 2015/06/15
Version: 2.0

Page: 1/10
(30487965/SDS_GEN_US/EN)

1. Identification

Product identifier used on the label

PT 4 ALLURE

Recommended use of the chemical and restriction on use

Recommended use*: insecticide

* The "Recommended use" identified for this product is provided solely to comply with a Federal requirement and is not part of the seller's published specification. The terms of this Safety Data Sheet (SDS) do not create or infer any warranty, express or implied, including by incorporation into or reference in the seller's sales agreement.

Details of the supplier of the safety data sheet

Company:

BASF CORPORATION
100 Park Avenue
Florham Park, NJ 07932, USA

Telephone: +1 973 245-6000

Emergency telephone number

CHEMTREC: 1-800-424-9300
BASF HOTLINE: 1-800-832-HELP (4357)

Registrant:

Whitmire Micro-Gen Research Laboratories, Inc.
3568 Tree Court Industrial Blvd.
St. Louis, MO 63122

Other means of identification

Chemical family: pheromone

2. Hazards Identification

According to Regulation 2012 OSHA Hazard Communication Standard; 29 CFR Part 1910.1200

Classification of the product

No need for classification according to GHS criteria for this product.

Label elements

Safety Data Sheet

PT 4 ALLURE

Revision date : 2015/06/15
Version: 2.0

Page: 2/10
(30487965/SDS_GEN_US/EN)

The product does not require a hazard warning label in accordance with GHS criteria.

According to Regulation 1994 OSHA Hazard Communication Standard; 29 CFR Part 1910.1200

Emergency overview

CAUTION:

KEEP OUT OF REACH OF CHILDREN.
KEEP OUT OF REACH OF DOMESTIC ANIMALS.
HARMFUL IF SWALLOWED.
Avoid contact with the skin, eyes and clothing.
Avoid inhalation of mists/vapours.

3. Composition / Information on Ingredients

According to Regulation 2012 OSHA Hazard Communication Standard; 29 CFR Part 1910.1200

This product does not contain any components classified as hazardous under the referenced regulation.

According to Regulation 1994 OSHA Hazard Communication Standard; 29 CFR Part 1910.1200

<u>CAS Number</u>	<u>Weight %</u>	<u>Chemical name</u>
31654-77-0		9,12-Tetradecadien-1-ol, 1-acetate, (9E,12Z)-

4. First-Aid Measures

Description of first aid measures

General advice:

First aid personnel should pay attention to their own safety. If the patient is likely to become unconscious, place and transport in stable sideways position (recovery position). Immediately remove contaminated clothing.

If inhaled:

Keep patient calm, remove to fresh air, seek medical attention.

If on skin:

Wash thoroughly with soap and water.

If in eyes:

Wash affected eyes for at least 15 minutes under running water with eyelids held open, consult an eye specialist.

If swallowed:

Immediately rinse mouth and then drink 200-300 ml of water, seek medical attention.

Most important symptoms and effects, both acute and delayed

Symptoms: The most important known symptoms and effects are described in the labelling (see section 2) and/or in section 11., Further important symptoms and effects are so far not known.

Safety Data Sheet

PT 4 ALLURE

Revision date : 2015/06/15
Version: 2.0

Page: 3/10
(30487965/SDS_GEN_US/EN)

Indication of any immediate medical attention and special treatment needed

Note to physician

Treatment: Treat according to symptoms (decontamination, vital functions), no known specific antidote.

5. Fire-Fighting Measures

Extinguishing media

Suitable extinguishing media:
foam, dry powder, carbon dioxide

Special hazards arising from the substance or mixture

Hazards during fire-fighting:

carbon monoxide,

If product is heated above decomposition temperature, toxic vapours will be released. The substances/groups of substances mentioned can be released in case of fire.

Advice for fire-fighters

Protective equipment for fire-fighting:

Firefighters should be equipped with self-contained breathing apparatus and turn-out gear.

Further information:

Evacuate area of all unnecessary personnel. Contain contaminated water/firefighting water. Do not allow to enter drains or waterways.

6. Accidental release measures

Personal precautions, protective equipment and emergency procedures

Take appropriate protective measures. Clear area. Shut off source of leak only under safe conditions. Extinguish sources of ignition nearby and downwind. Ensure adequate ventilation. Wear suitable personal protective clothing and equipment.

Environmental precautions

Do not discharge into the subsoil/soil. Do not discharge into drains/surface waters/groundwater. Contain contaminated water/firefighting water. A spill of or in excess of the reportable quantity requires notification to state, local and national emergency authorities. This product is not regulated by CERCLA ('Superfund').

Methods and material for containment and cleaning up

Dike spillage. Pick up with suitable absorbent material. Spilled substance/product should be recovered and applied according to label rates whenever possible. If application of spilled substance/product is not possible, then spills should be contained, solidified, and placed in suitable containers for disposal. After decontamination, spill area can be washed with water. Collect wash water for approved disposal.

7. Handling and Storage

Precautions for safe handling

RECOMMENDATIONS ARE FOR MANUFACTURING, COMMERCIAL BLENDING, AND PACKAGING WORKERS. PESTICIDE APPLICATORS & WORKERS must refer to the Product

Safety Data Sheet

PT 4 ALLURE

Revision date : 2015/06/15
Version: 2.0

Page: 4/10
(30487965/SDS GEN US/EN)

Label and Directions for Use attached to the product. Provide good ventilation of working area (local exhaust ventilation if necessary). Keep away from sources of ignition - No smoking. Keep container tightly sealed. Protect against heat. Handle and open container with care. Do not open until ready to use. Once container is opened, content should be used as soon as possible. Provide means for controlling leaks and spills. Follow label warnings even after container is emptied. The substance/product may be handled only by appropriately trained personnel. Avoid all direct contact with the substance/product. Avoid contact with the skin, eyes and clothing. Avoid inhalation of dusts/mists/vapours. Wear suitable personal protective clothing and equipment.

Protection against fire and explosion:

The relevant fire protection measures should be noted. Fire extinguishers should be kept handy. Avoid extreme heat.

Conditions for safe storage, including any incompatibilities

Segregate from incompatible substances. Segregate from foods and animal feeds. Segregate from textiles and similar materials.

Further information on storage conditions: Keep only in the original container in a cool, dry, well-ventilated place away from ignition sources, heat or flame. Protect containers from physical damage. Protect against contamination. The authority permits and storage regulations must be observed.

Storage stability:

May be kept indefinitely if stored properly.

If an expiry date is mentioned on the packaging/label this takes priority over the statements on storage duration in this safety data sheet.

8. Exposure Controls/Personal Protection

No occupational exposure limits known.

Advice on system design:

Whenever possible, engineering controls should be used to minimize the need for personal protective equipment.

Personal protective equipment

Respiratory protection:

Wear respiratory protection if ventilation is inadequate. Wear a NIOSH-certified (or equivalent) organic vapour/particulate respirator. For situations where the airborne concentrations may exceed the level for which an air purifying respirator is effective, or where the levels are unknown or Immediately Dangerous to Life or Health (IDLH), use NIOSH-certified full facepiece pressure demand self-contained breathing apparatus (SCBA) or a full facepiece pressure demand supplied-air respirator (SAR) with escape provisions.

Hand protection:

Chemical resistant protective gloves, Protective glove selection must be based on the user's assessment of the workplace hazards.

Eye protection:

Safety glasses with side-shields. Tightly fitting safety goggles (chemical goggles). Wear face shield if splashing hazard exists.

Body protection:

Body protection must be chosen depending on activity and possible exposure, e.g. head protection, apron, protective boots, chemical-protection suit.

Safety Data Sheet

PT 4 ALLURE

Revision date : 2015/06/15
Version: 2.0

Page: 5/10
(30487965/SDS_GEN_US/EN)

General safety and hygiene measures:

RECOMMENDATIONS FOR MANUFACTURING, COMMERCIAL BLENDING, AND PACKAGING WORKERS Wear long sleeved work shirt and long work pants in addition to other stated personal protective equipment. Work place should be equipped with a shower and an eye wash. Handle in accordance with good industrial hygiene and safety practice. Store work clothing separately. Keep away from food, drink and animal feeding stuffs.

9. Physical and Chemical Properties

Form:	liquid, oily
Odour:	mild, oily
Odour threshold:	Not determined due to potential health hazard by inhalation.
Colour:	colourless
pH value:	approx. 5.5 - 7.0 (1,000 g/l) The product has not been tested. The statement has been derived from substances/products of a similar structure or composition.
Melting point:	approx. 2 - 4 °C The product has not been tested. The statement has been derived from substances/products of a similar structure or composition.
Boiling point:	142 - 146 °C (3.99 hPa) The product has not been tested. The statement has been derived from substances/products of a similar structure or composition.
Flash point:	62 °C
Flammability:	not highly flammable
Lower explosion limit:	As a result of our experience with this product and our knowledge of its composition we do not expect any hazard as long as the product is used appropriately and in accordance with the intended use.
Upper explosion limit:	As a result of our experience with this product and our knowledge of its composition we do not expect any hazard as long as the product is used appropriately and in accordance with the intended use.
Vapour pressure:	approx. 0.16 - 6.9 Pa (20 °C)
Density:	approx. 0.88 - 0.89 g/cm ³ (25 °C)
Vapour density:	not applicable
Self-ignition temperature:	Based on its structural properties the product is not classified as self-igniting.
Thermal decomposition:	carbon monoxide, carbon dioxide Stable at ambient temperature. If product is heated above decomposition temperature toxic vapours may be released. To avoid thermal decomposition, do not overheat.
Viscosity, dynamic:	not determined
Solubility in water:	insoluble

Safety Data Sheet

PT 4 ALLURE

Revision date : 2015/06/15

Version: 2.0

Page: 6/10

(30487965/SDS GEN US/EN)

Evaporation rate: not applicable
Other Information: If necessary, information on other physical and chemical parameters is indicated in this section.

10. Stability and Reactivity

Reactivity

No hazardous reactions if stored and handled as prescribed/indicated.

Corrosion to metals:
Corrosive effects to metal are not anticipated.

Oxidizing properties:
Based on its structural properties the product is not classified as oxidizing.

Chemical stability

The product is stable if stored and handled as prescribed/indicated.

Possibility of hazardous reactions

The product is chemically stable.

Conditions to avoid

No conditions known that should be avoided.

Incompatible materials

air, strong oxidizing agents

Hazardous decomposition products

Decomposition products:
No hazardous decomposition products if stored and handled as prescribed/indicated., Prolonged thermal loading can result in products of degradation being given off.

Thermal decomposition:
Possible thermal decomposition products:
carbon monoxide, carbon dioxide
Stable at ambient temperature. If product is heated above decomposition temperature toxic vapours may be released. To avoid thermal decomposition, do not overheat.

11. Toxicological information

Primary routes of exposure

Routes of entry for solids and liquids are ingestion and inhalation, but may include eye or skin contact. Routes of entry for gases include inhalation and eye contact. Skin contact may be a route of entry for liquefied gases.

Acute Toxicity/Effects

Acute toxicity

Assessment of acute toxicity: Relatively nontoxic after single ingestion. Slightly toxic after short-term skin contact. Relatively nontoxic after short-term inhalation.

Oral

Type of value: LD50

Safety Data Sheet

PT 4 ALLURE

Revision date : 2015/06/15

Version: 2.0

Page: 7/10

(30487965/SDS_GEN_US/EN)

Value: > 5,000 mg/kg

The statement for acute oral toxicity was derived from products of similar composition.

Inhalation

Type of value: LC50

Species: rat

Value: > 5 mg/l

The statement for acute inhalative toxicity was derived from products of similar composition.

Dermal

Type of value: LD50

Species: rat

Value: > 2,000 mg/kg

Irritation / corrosion

Assessment of irritating effects: May cause slight but temporary irritation to the eyes. May cause moderate irritation to the skin.

Skin

Species: rabbit

Result: Irritant.

Data of a comparable product

Eye

Species: rabbit

Result: non-irritant

The product has not been tested. The statement has been derived from substances/products of a similar structure or composition.

Sensitization

Assessment of sensitization: Skin sensitizing effects were not observed in animal studies.

Species: guinea pig

Result: Non-sensitizing.

The product has not been tested. The statement has been derived from substances/products of a similar structure or composition.

Chronic Toxicity/Effects

Repeated dose toxicity

Assessment of repeated dose toxicity: No data required for Straight Chained Lepidopteran Pheromones (SCLP) following the recommendation of OECD [OECD Series on Pesticides, No. 12 - Guidance for Registration Requirements for Pheromones and Other Semiochemicals Used for Arthropod Pest Control, 26-Feb-2002 (ENV/JM/MONO (2001)12)]

Genetic toxicity

Assessment of mutagenicity: No data required for Straight Chained Lepidopteran Pheromones (SCLP) following the recommendation of OECD [OECD Series on Pesticides, No. 12 - Guidance for Registration Requirements for Pheromones and Other Semiochemicals Used for Arthropod Pest Control, 26-Feb-2002 (ENV/JM/MONO (2001)12)]

Carcinogenicity

Assessment of carcinogenicity: No data required for Straight Chained Lepidopteran Pheromones (SCLP) following the recommendation of OECD [OECD Series on Pesticides, No. 12 - Guidance for Registration Requirements for Pheromones and Other Semiochemicals Used for Arthropod Pest Control, 26-Feb-2002 (ENV/JM/MONO (2001)12)]

Reproductive toxicity

Safety Data Sheet

PT 4 ALLURE

Revision date : 2015/06/15
Version: 2.0

Page: 8/10
(30487965/SDS GEN US/EN)

Assessment of reproduction toxicity: No data required for Straight Chained Lepidopteran Pheromones (SCLP) following the recommendation of OECD [OECD Series on Pesticides, No. 12 - Guidance for Registration Requirements for Pheromones and Other Semiochemicals Used for Arthropod Pest Control, 26-Feb-2002 (ENV/JM/MONO (2001)12)]

Teratogenicity

Assessment of teratogenicity: No data required for Straight Chained Lepidopteran Pheromones (SCLP) following the recommendation of OECD [OECD Series on Pesticides, No. 12 - Guidance for Registration Requirements for Pheromones and Other Semiochemicals Used for Arthropod Pest Control, 26-Feb-2002 (ENV/JM/MONO (2001)12)]

Other Information

Misuse can be harmful to health.

Symptoms of Exposure

The most important known symptoms and effects are described in the labelling (see section 2) and/or in section 11., Further important symptoms and effects are so far not known.

12. Ecological Information

Toxicity

Aquatic toxicity

Assessment of aquatic toxicity:

Acutely toxic for fish. Acutely toxic for aquatic invertebrates. Very toxic (acute effect) to aquatic plants.

Toxicity to fish

(96 h) 8.3 mg/l, *Oncorhynchus mykiss* (static)

Aquatic invertebrates

EC50 (48 h) 1.13 mg/l, *Daphnia magna*

Aquatic plants

EC50 (72 h) 1.2 mg/l, *Pseudokirchneriella subcapitata* (static)

No observed effect concentration (72 h) 0.13 mg/l, *Pseudokirchneriella subcapitata* (static)

Persistence and degradability

Assessment biodegradation and elimination (H₂O)

Readily biodegradable (according to OECD criteria).

Bioaccumulative potential

Assessment bioaccumulation potential

No data required for Straight Chained Lepidopteran Pheromones (SCLP) following the recommendation of OECD [OECD Series on Pesticides, No. 12 - Guidance for Registration Requirements for Pheromones and Other Semiochemicals Used for Arthropod Pest Control, 26-Feb-2002 (ENV/JM/MONO (2001)12)]

Mobility in soil

Assessment transport between environmental compartments

The substance will rapidly evaporate into the atmosphere from the water surface

Safety Data Sheet

PT 4 ALLURE

Revision date : 2015/06/15
Version: 2.0

Page: 9/10
(30487965/SDS_GEN_US/EN)

Study not necessary due to exposure considerations.

Additional information

Other ecotoxicological advice:
Do not discharge product into the environment without control.

13. Disposal considerations

Waste disposal of substance:

Do not discharge into waterways or sewer systems without proper authorization. Dispose of in accordance with national, state and local regulations. Dispose of in a licensed facility. Residues should be disposed of in the same manner as the substance/product.

Container disposal:

Completely empty packaging may be treated as household waste. Recommend crushing, puncturing or other means to prevent unauthorized use of used containers. Do not reuse empty containers.

14. Transport Information

Land transport USDOT

Not classified as a dangerous good under transport regulations

Sea transport IMDG

Not classified as a dangerous good under transport regulations

Air transport IATA/ICAO

Not classified as a dangerous good under transport regulations

15. Regulatory Information

Federal Regulations

Registration status:

Chemical TSCA, US released / listed

Crop Protection TSCA, US released / exempt

EPCRA 311/312 (Hazard categories): Acute;

16. Other Information

SDS Prepared by:
BASF NA Product Regulations
SDS Prepared on: 2015/06/15

Safety Data Sheet

PT 4 ALLURE

Revision date : 2015/06/15
Version: 2.0

Page: 10/10
(30487965/SDS_GEN_US/EN)

We support worldwide Responsible Care® initiatives. We value the health and safety of our employees, customers, suppliers and neighbors, and the protection of the environment. Our commitment to Responsible Care is integral to conducting our business and operating our facilities in a safe and environmentally responsible fashion, supporting our customers and suppliers in ensuring the safe and environmentally sound handling of our products, and minimizing the impact of our operations on society and the environment during production, storage, transport, use and disposal of our products.

IMPORTANT: WHILE THE DESCRIPTIONS, DESIGNS, DATA AND INFORMATION CONTAINED HEREIN ARE PRESENTED IN GOOD FAITH AND BELIEVED TO BE ACCURATE , IT IS PROVIDED FOR YOUR GUIDANCE ONLY. BECAUSE MANY FACTORS MAY AFFECT PROCESSING OR APPLICATION/USE, WE RECOMMEND THAT YOU MAKE TESTS TO DETERMINE THE SUITABILITY OF A PRODUCT FOR YOUR PARTICULAR PURPOSE PRIOR TO USE. NO WARRANTIES OF ANY KIND, EITHER EXPRESSED OR IMPLIED, INCLUDING WARRANTIES OF MERCHANTABILITY OR FITNESS FOR A PARTICULAR PURPOSE, ARE MADE REGARDING PRODUCTS DESCRIBED OR DESIGNS, DATA OR INFORMATION SET FORTH, OR THAT THE PRODUCTS, DESIGNS, DATA OR INFORMATION MAY BE USED WITHOUT INFRINGING THE INTELLECTUAL PROPERTY RIGHTS OF OTHERS. IN NO CASE SHALL THE DESCRIPTIONS, INFORMATION, DATA OR DESIGNS PROVIDED BE CONSIDERED A PART OF OUR TERMS AND CONDITIONS OF SALE. FURTHER, YOU EXPRESSLY UNDERSTAND AND AGREE THAT THE DESCRIPTIONS, DESIGNS, DATA, AND INFORMATION FURNISHED BY OUR COMPANY HEREUNDER ARE GIVEN GRATIS AND WE ASSUME NO OBLIGATION OR LIABILITY FOR THE DESCRIPTION, DESIGNS, DATA AND INFORMATION GIVEN OR RESULTS OBTAINED, ALL SUCH BEING GIVEN AND ACCEPTED AT YOUR RISK.
END OF DATA SHEET